

January 9, 1991
NX89-2.HDM

Introduced by: Laing

Proposed No.: 91 - 92

ORDINANCE NO. **9850**

AN ORDINANCE relating to the annexation of an area known as 89-2 to Sammamish Plateau Water and Sewer District, for the provision of water and sewer service.

STATEMENT OF FACT:

1. A notice of intention proposing the annexation of an area known as 89-2 to Sammamish Plateau Water and Sewer District was filed with the county council effective January 5, 1991.

2. Sammamish Plateau Water and Sewer District has found the petition for annexation to be sufficient and has, by Resolution No. 1275 concurred with the proposed annexation.

3. Sammamish Plateau Water and Sewer District filed a Declaration of Non-significant Impact dated November 5, 1990, on the proposed annexation.

4. The county council held a public hearing on the 11th day of March, 19 91 and has considered the criteria set forth in R.C.W. 57.02.040, and R.C.W. 56.02.060.

BE IT ORDAINED BY THE COUNCIL OF KING COUNTY:

SECTION 1. The annexation by Sammamish Plateau Water and Sewer District of the area known as 89-2 and described in Section 4 herein is approved. This proposed annexation is consistent with R.C.W. 57.02.040, and R.C.W. 56.02.060, as described in the attached King County Council Annexation Report on 89-2.

SECTION 2. Sammamish Plateau Water and Sewer District is the appropriate entity to serve the area proposed to be annexed.

SECTION 3. Completion of this annexation does not constitute county approval or disapproval of any other permits, certifications, or actions necessary to provide service to this annexation area, nor does it authorize sewer service in any

1 area not designated as a "Local Service Area" by the King
2 County Sewerage General Plan.

3 SECTION 4. The area known as 89-2 to be annexed is
4 described as follows:

5 That portion of Section 7, Township 24 North, Range 6 East,
6 W.M., King County, Washington, described as follows:

7 The Southeast 1/4 of the Northeast 1/4 of said Section 7
8 less those portions previously annexed as part of the District
9 by Sammamish Plateau Water and Sewer District Resolution A-
10 108, Resolution #21, Resolution #58-7-18 and Resolution #57-
11 10-8.

12 INTRODUCED AND READ for the first time this 22nd day
13 of January, 1991.

14 PASSED this 11th day of March, 1991.

15 KING COUNTY COUNCIL
16 KING COUNTY, WASHINGTON

17 Lois North
18 Chair

19 ATTEST:

20 Gerald A. Peterson
21 Clerk of the Council

22 APPROVED this 22nd day of March, 1991.

23 Jim Hill
24 King County Executive

91 JAN -2 AM 8:06

CLERK
KING COUNTY COUNCIL

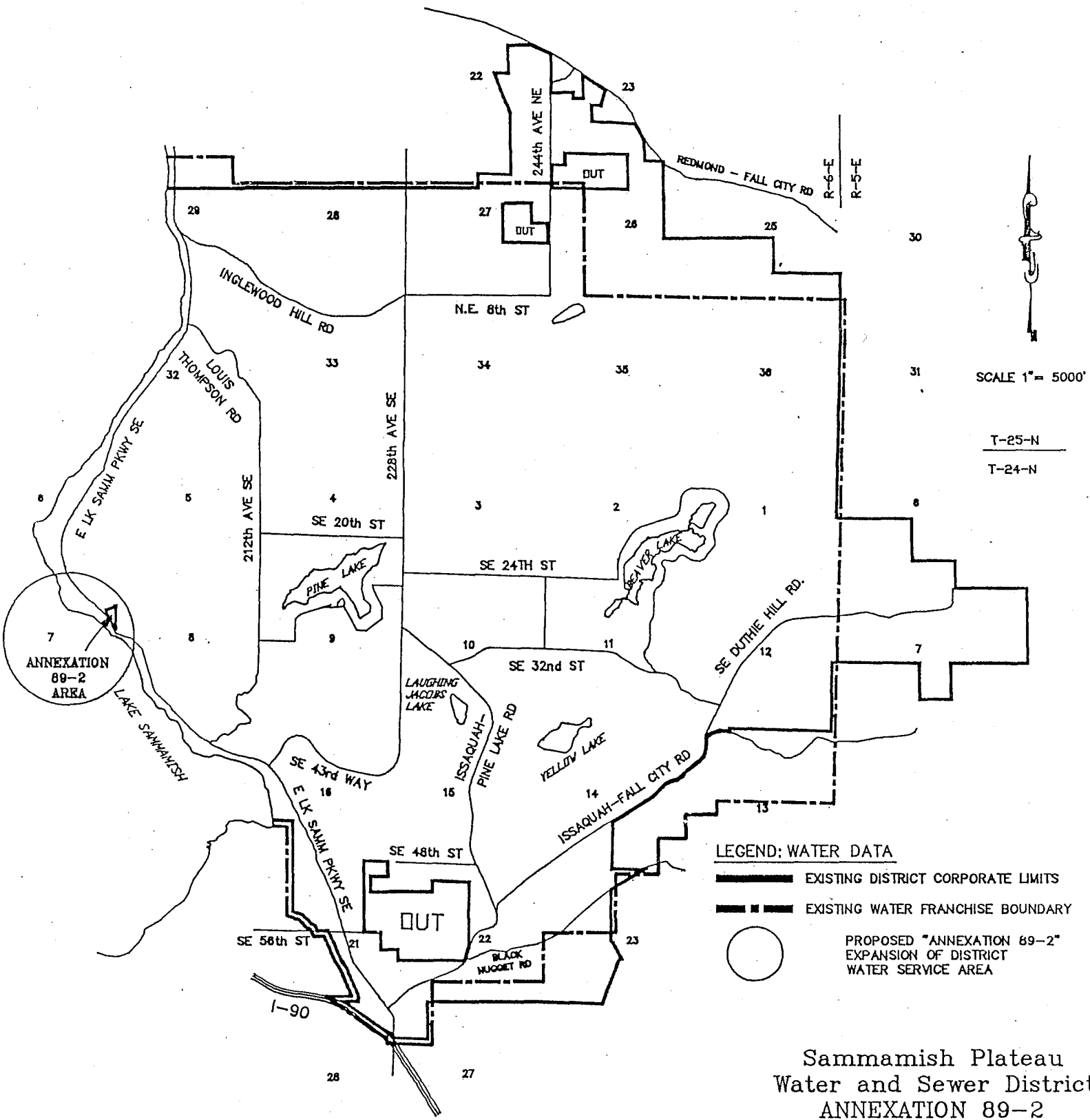

Sammamish Plateau
Water and Sewer District
ANNEXATION 89-2